

**NOTES**

**GENERAL CLEARANCE BEFORE PLANTING AND SPREADING TOPSOIL**

1. All rubble, stone over 150 mm, general rubbish and builders' debris to be cleared from the proposed planting areas to the depth of the cultivated medium depending if trees, shrubs or grass (see spec for depths) and removed from site to an approved tip prior to any cultivation works.
2. The planting area shall be treated with an approved herbicide 2 weeks before spreading topsoil.

**SITE PREPARATION**

1. Following herbicide treatment (duration depending on herbicide type) the entire area shall be leveled to a medium grade prior to topsoil being spread.
2. Topsoil to be cultivated so free of grass, pernicious weeds and weed seed, stones larger than 50 mm and other debris. Similarly the top 50 mm of subsoil for grass areas should be free of grass, pernicious weeds and weed seed, stones larger than 30 mm and other debris.
3. Topsoil to be spread in 150 mm layers and gently firmed. Subsoil to be spread in 300 mm layers and gently firmed.

**PLANT MATERIAL**

1. All plant material shall be pest and disease free.
2. Topsoil shall be supplied in accordance with BS3882.
3. All plants to be planted at the same depth as previously grown.
4. Sufficient soil must be removed to allow all roots to fully spread. Care must be taken with root systems - with dry, damaged roots being carefully pruned prior to planting.

**PLANTING**

**General**

**Times of year for planting:**

- Deciduous trees and shrubs : November to March.
- Conifers and evergreens : November to March.
- Container grown plants : At any time if ground and weather conditions are favorable.
- Watering and weed control : Provide as necessary.

Refer to Plant Schedule for species, sizes and planting densities.

**Trees**

1. Soil ameliorants to consist of an approved compost, at 20L for each feathered tree and 12-14cm gth tree, 35L for each 14-18cm gth tree and 50L for each 20-25 cm gth tree and 150g/tree of 10.10.10 NPK slow release fertilizer and 0.1% by weight of 'BroadLeaf' P4 water retentive gel.
2. For further details, see drawing no. tree planting details.

All planting to be watered thoroughly immediately after planting without damaging or displacing plants or soil.



Pp - Cherry (Prunus padus 'Fastigiata') Residential Streetscape

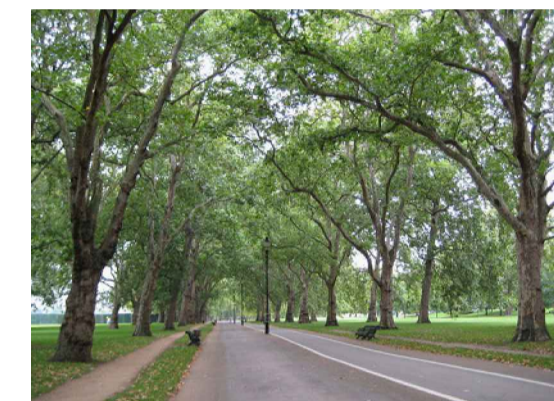

Ph - London Plane (Platanus x hispanica) Avenue



Bp - Birch (Betula pendula) Woodland

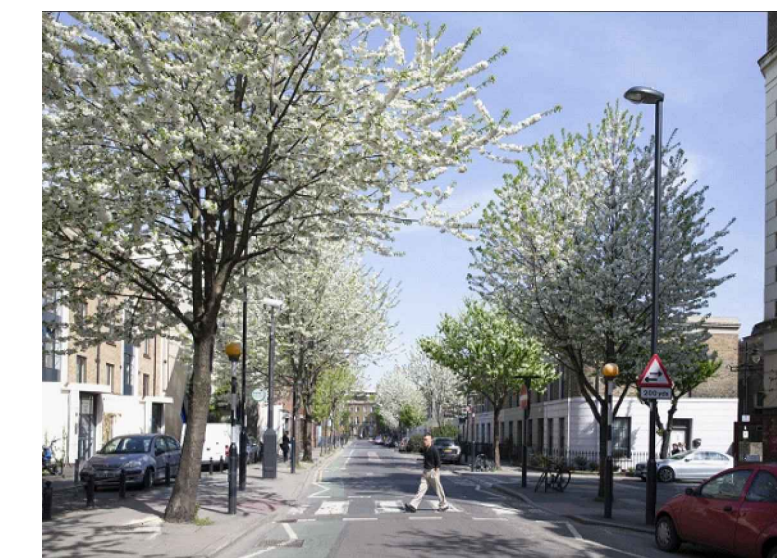

Pp - Cherry (Prunus padus 'Fastigiata') Streetscape



Ac - Field Maple (Acer campestre 'Elsrijk')



Sa - Pin Oak (Quercus palustris)



Cycle/pedestrian paths



Mixed tree planting Streetscape



Ul - Elm (Ulmus 'Lobel') streetscape



Gt - Golden Cappadocian Maple (Acer cappadocicum 'Aureum')



Cl - Lebanese Cedar (Cedrus libani)

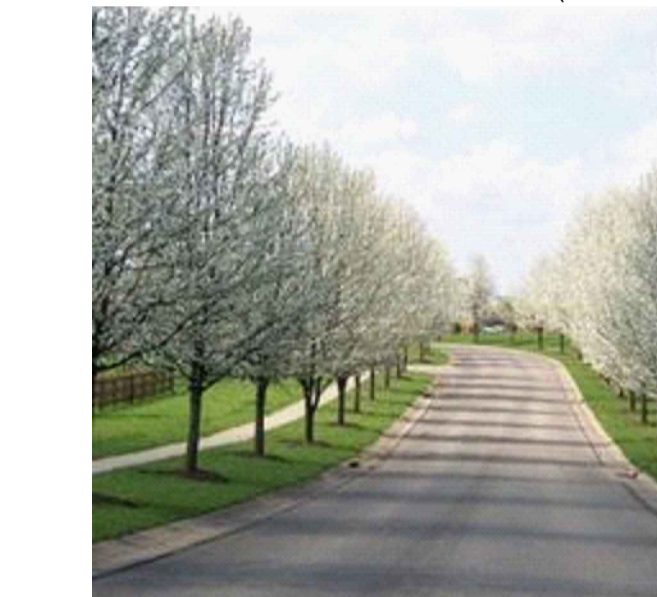

Tc - Lime (Tilia cordata 'Green Spire') Avenue

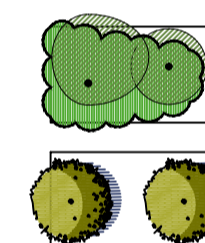

**Existing Trees managed and retained**  
(See arborists report)



**Proposed Street Trees**

Planted in same species groups or lines on individual streets

**Large Trees**

*Corylus colurna* 14-16cm gth, 5-6m ht  
*Tilia cordata* 'Greenspire' 16-18cm, 5-6m ht  
*Ulmus 'Lobel'* 16-18cm, 5-6m ht  
*Acer cappadocicum* 'Aureum' 16-18cm, 5-6m ht  
*Acer campestre* 16-18cm, 5-6m ht  
*Prunus padus* 'Fastigiata'

**Medium Trees**

*Pyrus 'Chanticleer'*, 14-16cm, 3-4m ht  
*Quercus palustris* 12-14cm, 2.5-3.5m ht  
*Acer campestre* 'Streetwise' 16-18 cm gth, 4-6m ht  
*Acer campestre* 'Elsrijk' 16-18cm gth, 4-6m ht

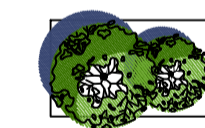

**Proposed Parkland, Open Spaces and Feature Trees (572 no.)**

To include species from the above list and selected species from the following:

**Large Trees**

*Acer pseudoplatanus* 14-16cm, 4.25-6m ht  
*Fagus sylvatica* 14-16cm, 4.25-6m ht  
*Platanus x hispanica* 14-16cm, 4.25-6m ht  
*Aesculus hippocastanum* 14-16cm, 4.25-6m ht  
*Quercus robur* 'Fastigiata' 14-16cm, 4.25-6m ht

**Medium Trees**

*Pyrus 'Chanticleer'*, 14-16cm, 3-4m ht  
*Quercus palustris* 12-14cm, 2.5-3.5m ht

**Specimens:**  
*Cedrus libani* 120-150cm, RB

Underplanted with selected bulbs - Narcissus and Hyacinthoides non-scripta

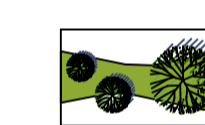

**Proposed Native Trees**

**Large Trees**

*Betula pendula* 12-14cm, 2.5-3.5m ht  
*Alnus glutinosa* 12-14cm, 2.5-3.5m ht  
*Populus tremula* 12-14cm, 2.5-3.5m ht

**Small Trees**

*Salix caprea* 12-14cm, 2.5-3.5m ht  
*Corylus avellana* 12-14cm, 2.5-3.5m ht

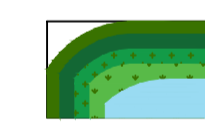

**Shrub planting**

Indicative species list

**Aquatic & marginal plants to include:**

- 2L min. pot size and planted at 4/m2

Species tolerant of fluctuating water levels and duration  
Phragmites australis (common reed)  
Phalaris arundinacea (reed canary grass)  
Persicaria amphibian (amphibious bistort)

Species requiring shallow standing water at all times  
Sparganium erectum (branched bur-reed)  
Glyceria fluitans (flote-grass)  
Typha latifolia (reed mace)

Species requiring moderate to deep standing water at all times  
Schoenoplectus lacustris (common club-rush)  
Myriophyllum spicatum (spiked water-milfoil)  
Potamogeton species (pond weeds)

**Amenity Grass**

**Wildflower Meadow**

**Existing Ditch /Stream**  
to include riparian planting to banks

**Brushed Concrete Footpath**  
-to Engineers Detail

**Tarmac Cycleway**  
-To Engineers Detail

REV	DATE	AMENDMENT

**CUNNANE STRATTON REYNOLDS**  
**LAND PLANNING & DESIGN**

DUBLIN OFFICE  
3 MOLESWORTH PLACE DUBLIN 2  
TEL 01 661 0419 FAX 01 661 0431  
EMAIL info@cslandplan.ie



**Note:**  
All Landscape details shown are preliminary and will be further developed at detail design stage.  
All boundary treatments to be agreed with affected landowners.

PROJECT:  
**GLENAMUCK DISTRICT ROADS SCHEME**  
DUN LAOGHAIRE RATHDOWN COUNTY COUNCIL

DRAWING:  
**LANDSCAPE KEY PLAN**

DATE:	DECEMBER 2018
SCALE:	1:5000 @ A1 1:10000 @ A3
DRAWN:	DL
CHECKED:	DOL
DRAWING NO.:	17479-2-100
EIAR FIGURE REF:	12.0